

Basic components of the tool setting system

- ◆ Automatic swing arm LTA (including connecting cables);
- ◆ Tool setting probe TP3;
- ◆ Interface APT-6 (including connecting cables);
- ◆ Tool setting probe storage box;
- ◆ Tool setting software package.

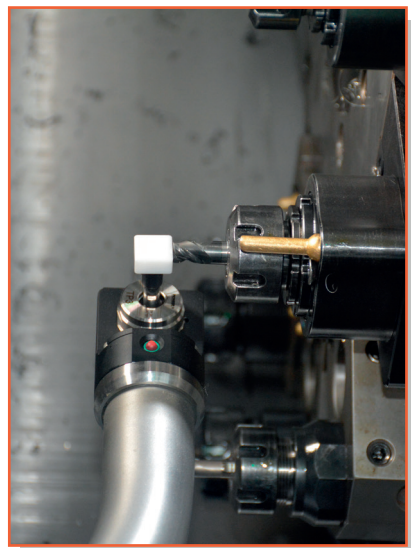
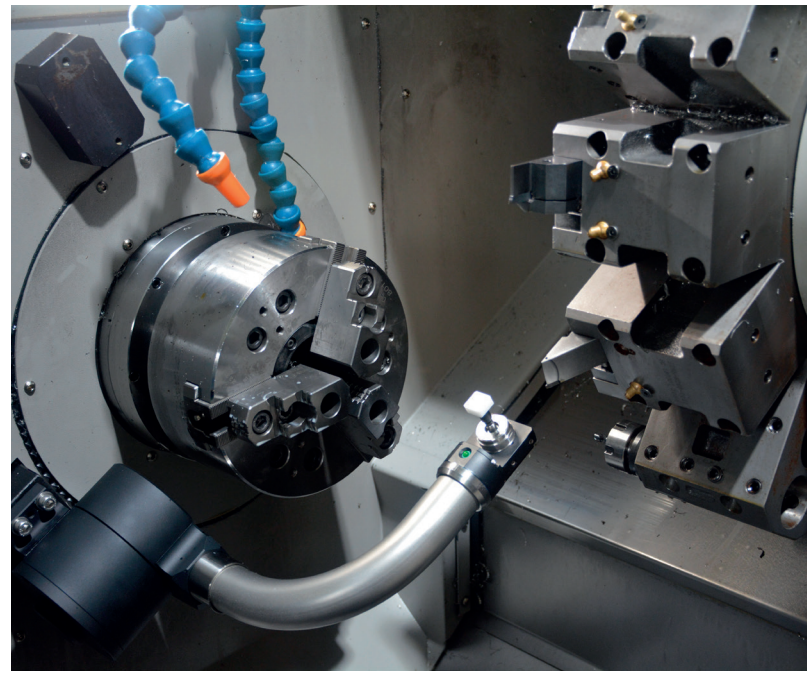
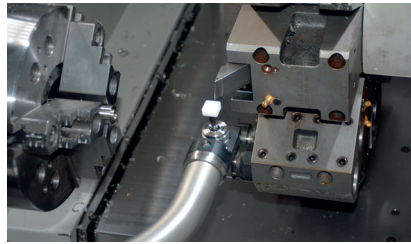

Application of tool setting system

- ◆ Provides a platform for multiple applications for tool setting, tool breakage detection and workpiece detection;
- ◆ Releases the processing potential of machine tools, realizes large-scale unmanned production, and ensures the consistency and reliability of processing.

Notes on purchase

If you purchase our LTS-10 tool setting system, which includes the basic configuration of tool setting probe, control box, automatic swing arm and tool setting software (see details page), please consult our sales staff whether the CNC system used by the machine tool to be installed can be equipped with the LTS-10 tool setting system. Some CNC systems require additional settings to use this product;

If you want to change the configuration, please pay attention to the following tips:

- ◆ Regarding the installation dimensions of the tool setting system, please verify the chuck size and tool size of your machine tool before ordering this product, and select the appropriate product according to the order form provided by our company;
- ◆ Regarding the stylus of the TP3 tool setting probe, please purchase according to the stylus size corresponding to the tool square specification. For details, please consult our staff;
- ◆ Regarding the cable length, verify whether the length of the connecting cable between the automatic swing arm LTA and the interface can meet the installation requirements; the cable is optional 3m/5m/10m, please specify when ordering this product.

The above configuration changes will lead to price fluctuations and extended delivery cycles for this product. Please understand.

Application

- ◆ Set lengths parameter of cutting tools automatically before CNC processing;
- ◆ Detect wear and breakage of cutting tools automatically between two processes or after the CNC processing;
- ◆ Through checking cutting tool parameters to control the change of machining precision from the temperature change of the machine;

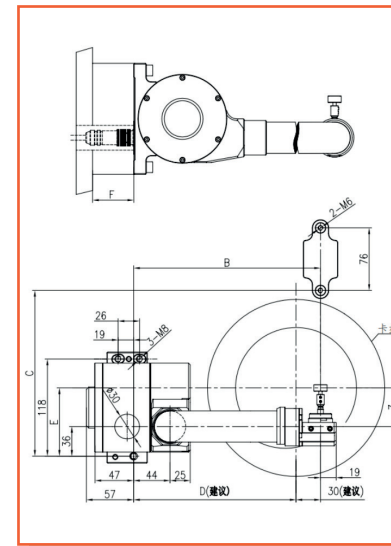
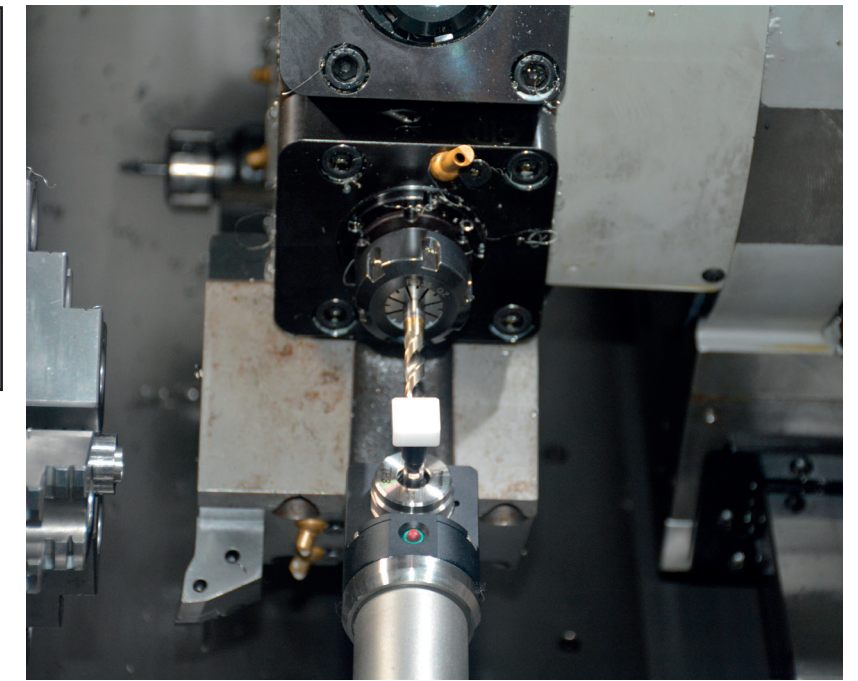

Technical parameters of automatic swing arm

- ◆ Repeatability:
6in-16in chuck: ± 0.005 mm 2σ X/Z;
18in-24in chuck: ± 0.010 mm 2σ X/Z;
- ◆ Arm sweep time: ≈ 2 s;
- ◆ LTS-10 Operating environment temperature: $+5^{\circ}\text{C}$ — $+50^{\circ}\text{C}$;
- ◆ LTA Indicator Lights (LED) : 1pcs;
- ◆ Overall IP rating of tool setting arm: IP68;
- ◆ TP3 probe measurement direction: $\pm X$, $\pm Z$;
- ◆ Stylus size: 16*16*8;
- ◆ Stylus overtravel : Z: 5.0 (mm) , X and Y : 12°;
- ◆ Stylus Repeatability : 0.002 (mm) ;
- ◆ Stylus trigger force (Radial) : 200-350 (g) ;
- ◆ Stylus trigger force (Axial): 1000-1200 (g) .